

# SEATING ARRANGEMENTS

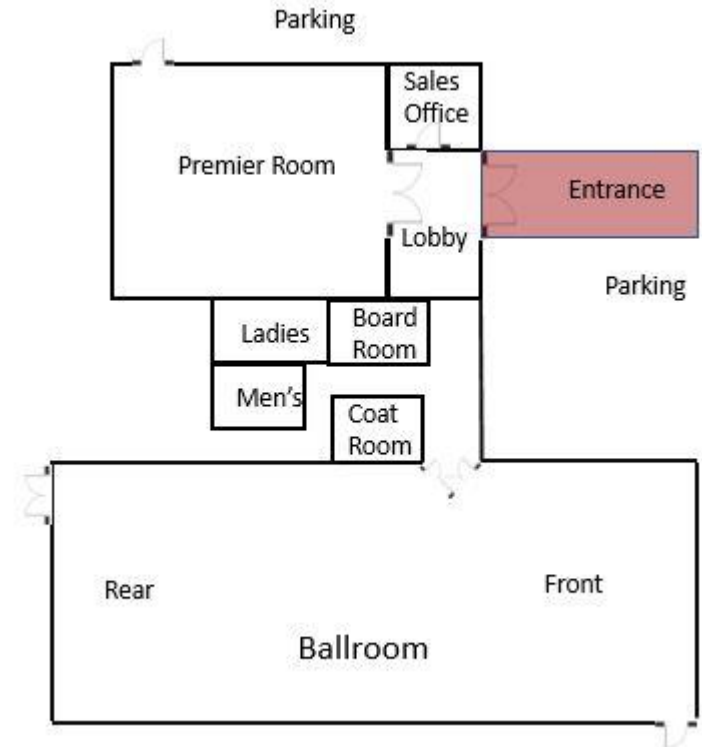

## Corporate Style Seating

Room	Banquet Rounds 8-10 guests/ w/ maximum capacity table	Classroom 3-4 guests/ table	Theater with isles	U- Shape 4 guests/ 8' meeting table	Crescent 6 guests/ table
Premier Room	50 guests	40 guests	100 guests	25 guests	30 guests
Board Room	10 guests	N/A	15 guests	8 guests	6 guests
Front Ball Room	60 guests	35 guests	100 guests	32 guests	30 guests
Rear Ball Room	110 guests	72 guests	140 guests	40 guests	80 guests
<b>Full Ballroom</b>	200 guests 2 screens	80 guests 2 screens	240 guests	40 guests with space for displays	150 guests 2 screens
Each seating arrangement assumes buffet service and presentation with either projector and screen or Flat screen TV.					

